



Commercial, Industrial & Chemical Tanks Catalogue



 **Tankmasta**[®]
Because; not all tanks are created equal.

Viscount Rotational Mouldings Pty. Ltd.
81 Frankston Gardens Drive
Carrum Downs, 3201,
Victoria, Australia
ABN: 19067462337

Sales Enquires: 1300 366 685
Fax: (03) 8770 3201
Tel: (03) 87703200
Email: vrmsales@viscount.com.au
Web: www.viscountroto.com.au

 A Viscount Group Company

Edition III

Tankmasta

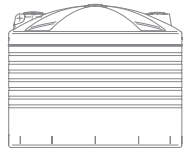

Viscount Rotational Mouldings' (VRM) Tankmasta manufacture an extensive range of freestanding commercial and industrial liquid storage as well as chemical tanks to suit most situations.

Made from chemical resistant, food grade, LLDPE resin, our tanks are capable of handling product up to a specific gravity up to 1.6 and an operational temperature range from -18 degrees to +60 degrees celsius.

The cylindrical designs have capacities ranging from 115 litres to 25,000 litres while offering the structural integrity associated with one-piece construction and without vertical seams.

Tanks are moulded in a variety of coloured resins, the UV stabilized material allowing for both internal or external applications.

checklist:

Please consider the following information, as it will be required to supply a quotation and to fulfill an order. The positions of the roof access points are as per the diagrams on page 3. Larger manhole covers can be installed though this will be dependent on the structural integrity of the roof being preserved.

Dealer Name: *The primary contact person, who we receive the order from and invoice.*

Delivery Address: *Required for a quotation to calculate freight and if RTA permits would be required. Note: Freight not included unless stipulated.*

Customer Contact Details:

Contact name (preferably at delivery site) and contact telephone number - required for delivery confirmation.

Customer Name: *Not required for quotation but mandatory when an order is placed into our system.*

Mailing Address: *To forward order confirmation letter that states our internal order reference details.*

Tank / Vessel: *Tank code and size i.e. CT0200 20,000 ltr. Chemical Tank*

Quantity Required: *Note: Multiple tanks delivered simultaneously may improve transport efficiencies.*

Tank Colour: *Natural, Black or colour of material*

Required Delivery Date: *Anticipated delivery date or critical contractual requirements.*

Type Of Liquid / Product Being Stored - i.e Water

S.G. Rating: i.e. 1.0

Components / Fittings: i.e.

2 x 33TF0124 - 80mm Poly Compression Fitting

2 x 33TF0076 - 80mm PVC Ball Valve

1 x 33TF0046 - PE Lid & Ring with breather

4 x 33TF0212 - Anchor Brackets

Locations of fittings:

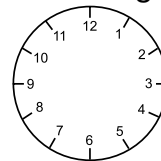

Required placement of access hatch:

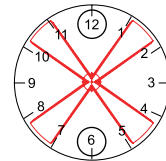

Special Transport Requirements: *i.e. Crane / delivery inside a building / low roofline, etc.*

Site Access Issues: *Includes site hours, access for vehicles, working at heights, specific OH&S requirements, site induction (red card) requirements or testing for certifications.*

Additional Comments:

round large tanks:

1.0-1.6 S.G.

Ranging from 1kl to 25kl, the design of VRM's commercial, industrial and chemical tanks is an extension of the criteria used when we developed our range on AS/NZS4766 certified tanks. As a result VRM's tanks share the same patented ADP roof support system eliminating the requirement for any type of internal roof support. Rated from a Specific Gravity (S.G.) of 1.0 (commercial and industrial tanks) to 1.6 (chemical tanks).

Note: The use of larger than standard fittings requires a thicker wall structure to maintain the tanks integrity. In these applications a chemical tank must be used.

product	code water - 1.0 S.G.	code chemical - 1.6 S.G.	capacity	diameter	total height
T2 round tank	TA0010	CT0010	1,000Ltr.	830mm	2100mm
T2 round tank	TA0020	CT0020	2,000Ltr.	1180mm	2100mm
T2 round tank	TA0030	CT0030	3,000Ltr.	1450mm	2100mm
T2 round tank	TA0050	CT0050	5,000Ltr.	1880mm	2100mm
T2 round squat tank	TA0052	CT0052	5,200Ltr.	2280mm	1615mm
T2 round tank	TA0075	CT0075	7,500Ltr.	2280mm	2115mm
T2 round tank	TA0100	CT0100	10,000Ltr.	2500mm	2345mm
T2 round squat tank	TA0102	CT0102	10,200Ltr.	3080mm	1685mm
T2 round tank	TA0150	CT0150	15,000Ltr.	3080mm	2385mm
T2 round tank	TA0200	CT0200	20,000Ltr.	3580mm	2500mm
T2 round tank	TA0225	CT0225	22,500Ltr.	3580mm	2730mm
T2 round tank	TA0250	CT0250	25,000Ltr.	3580mm	2960mm

Please note that all dimensions are nominal.

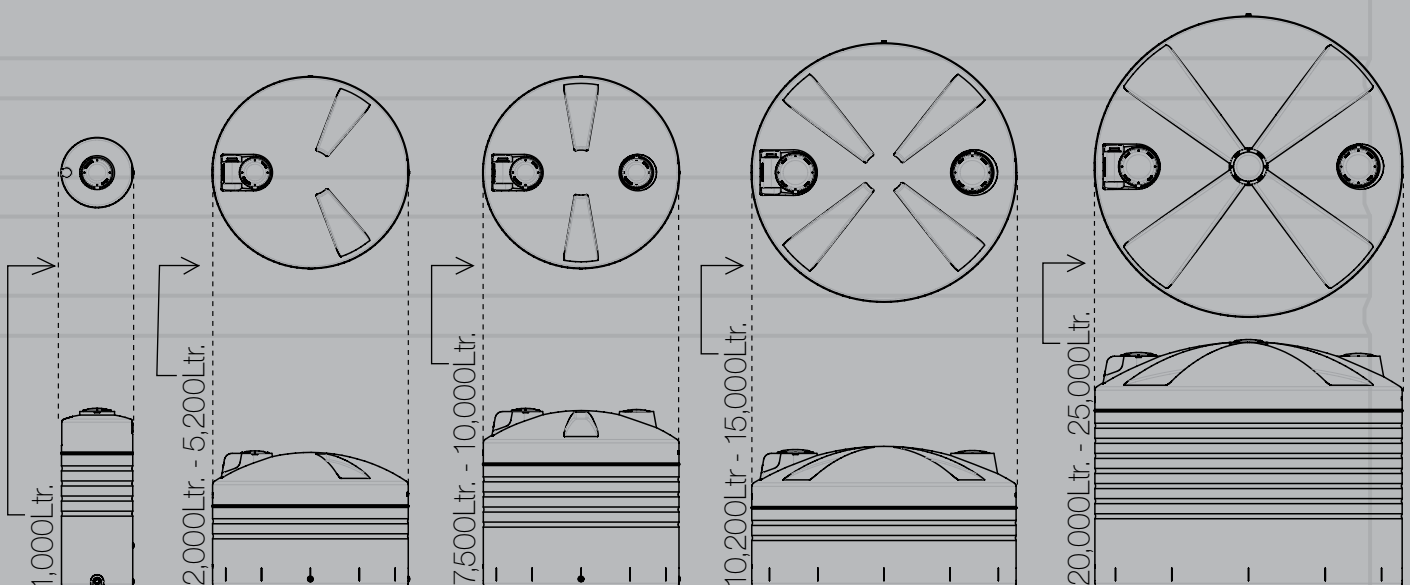

hopper skins:

1.0 S.G.

product	code	capacity	diameter	total height
hopper skins	CH1031	230Ltr.	630mm	1110mm
hopper skins	CH1722	1,000Ltr.	1090mm	1435mm
hopper skins	CH1721	1,600Ltr.	1090mm	2035mm

Please note that all dimensions are nominal.

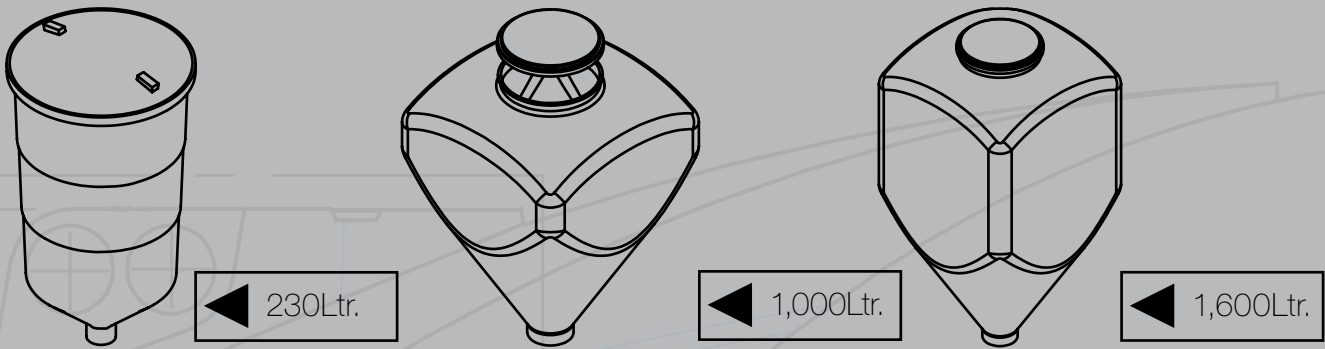

The hopper skins are available in three varying conical designs, capable of housing both liquids and powders and rated to an S.G. of 1.0 when supported in a correctly designed frame. Further information regarding outlets, slides, lids and frame designs is available by contacting VRM direct on 1300 366 685

transporter tanks:

1.0 S.G.

product	code	capacity	length	width	total height
transporter tank	CT1420	340Ltr.	650mm	1180mm	674mm
transporter tank	CT1462	600Ltr.	1050mm	1050mm	700mm
transporter tank	CT1460	800Ltr.	1525mm	1200mm	800mm
transporter tank	CT1461	1,100Ltr.	1525mm	1200mm	1070mm

Please note that all dimensions are nominal.

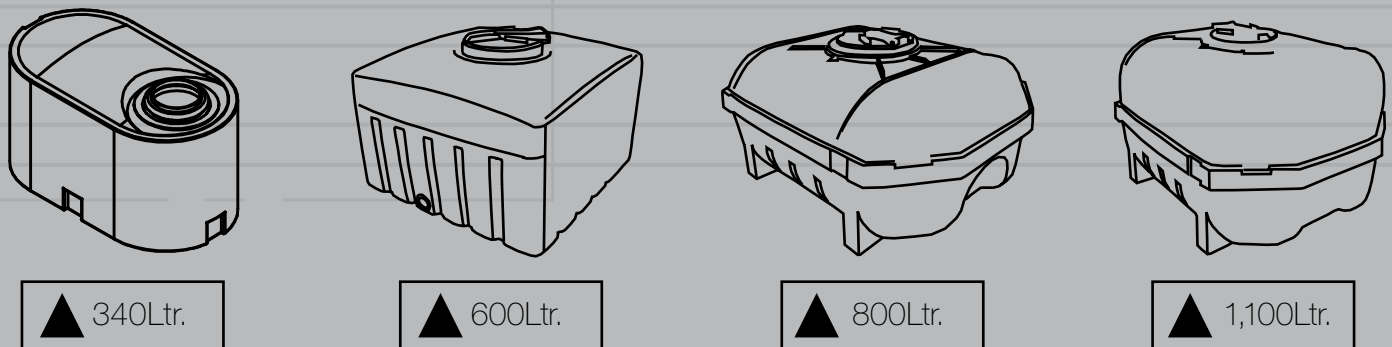

The range of transportation tanks are suitable for the storage of liquids with a S.G. rating of 1.0. Rectangular tanks can be strapped to the trailer or utility for easy transportation of stored liquids. The tanks come standard with lid. Fittings are to customer's specifications.

closed head drum:

1.6 S.G.

product	code	capacity	diameter	total height
closed head drum	CT1605	110Ltr.	495mm	675mm
closed head drum	CT1606	218Ltr.	590mm	865mm
closed head drum	CT1607	260Ltr.	590mm	1040mm

Please note that all dimensions are nominal.

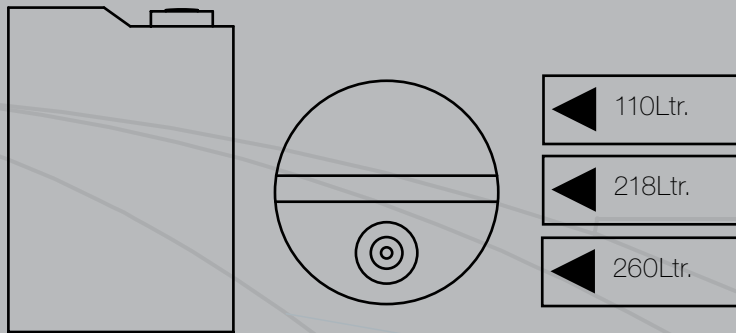

Ranging from 110Ltr. to 260Ltr. Closed head drums offer a freestanding unit to store liquids or powders with a S.G of 1.6. Drum comes standard with screw cap and plug.

nesting drums & lids:

1.6 S.G.

product	code	capacity	diameter	total height
nesting drum	CT1640	40Ltr.	430mm	460mm
nesting drum lid	CT1641	-	440mm	40mm
nesting drum	CT1643	60Ltr.	490mm	450mm
nesting drum lid	CT1644	-	520mm	45mm
nesting drum	CT1647	115Ltr.	532mm	710mm
nesting drum lid	CT1649	-	552mm	60mm
nesting drum	CT1648	215Ltr.	635mm	920mm
nesting drum lid	CT1653	-	670mm	60mm

Please note that all dimensions are nominal.

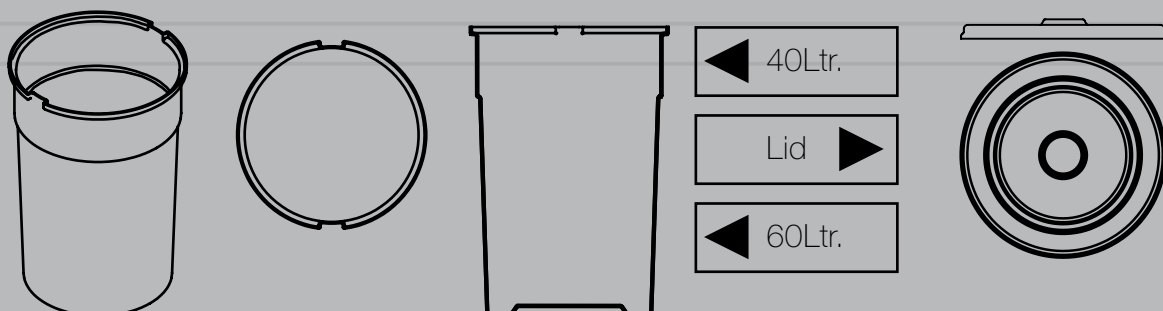

Nesting drums offer a storage solution that is nestable for economical freight and storage and capable of housing properties with an S.G. up to 1.6. Compatible lids are available.

circular tanks:

1.6 S.G.

product	code	capacity	max diameter	total height	lid height
circular tank (detached roof)	CT1270	375Ltr.	950mm	615mm	190mm
circular tank (detached roof)	CT1266	555Ltr.	950mm	915mm	190mm
circular tank (detached roof)	CT1268	680Ltr.	950mm	1115mm	190mm
circular tank	CT1264	495Ltr.	950mm	845mm	-
circular tank	CT1272	680Ltr.	950mm	1150mm	-
circular tank	CT1276	800Ltr.	950mm	1345mm	-
circular tank	CT1200	1,200Ltr.	1300mm	1300mm	-

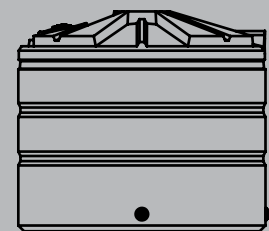
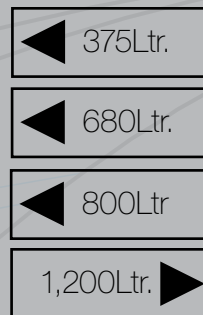
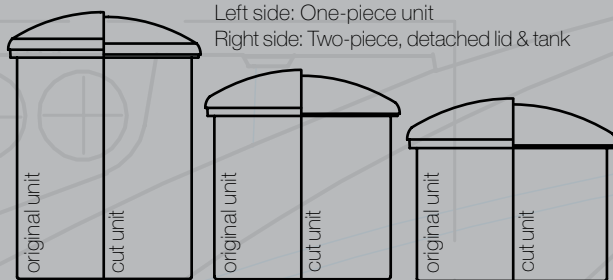

Circular tanks provide storage with a S.G. rating of 1.6. They are a self-contained unit moulded with the lid in place but offer the option of having the lid removable.

chemical fittings:



Listed below are groupings of the most popular fittings.

- If you require a fitting not listed here, please contact the team at VRM for further assistance.
- Note: If the storage vessel is to be used with a corrosive material, it is the purchaser's responsibility to specify any critical requirement of the fittings being supplied. This is particularly important when fittings contain seals and o-rings that must have a specific chemical resistance.
- Chemical fittings material specifications are available upon request.
- Fittings warranted under manufacturer's specific terms, for more details contact VRM direct.
- The fittings in the tables below fall into three categories of suitable application: 'W' represents suitable for the storage of water, 'C' represents commercial application & 'Ch' represents fittings with a chemical resistance.

Banjo Stubby

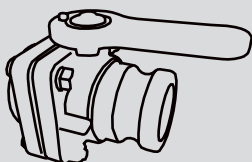

Part No	Description	Water	Commercial	Chemical
23TF0082	Stubby Composite Ball Valve Full Flow - 50mm (2")	✓	✓	✓
23TF0079	Stubby Composite Ball Valve with Camlock - 50mm (2")	✓	✓	✓

Brass Gate Valve

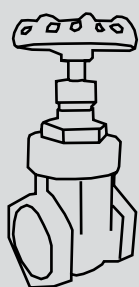

Part No	Description	W	C	Ch
23TF0010	Brass Isolation Valve - 25mm (1")	✓	✓	
23TF0260	Brass Isolation Valve - 32mm (1 1/4")	✓	✓	
23TF0011	Brass Isolation Valve - 40mm (1 1/2")	✓	✓	
23TF0012	Brass Isolation Valve - 50mm (2")	✓	✓	
23TF0261	Brass Isolation Valve - 65mm (2 1/2")	✓	✓	
23TF0262	Brass Isolation Valve - 80mm (3")	✓	✓	
23TF0014	Brass Isolation Valve - 100mm (4")	✓	✓	

PE Ball Valve

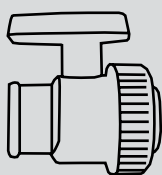

Part No	Description	W	C	Ch
23TF0080	PE Ball Valve - 20mm (3/4")	✓	✓	✓
23TF0081	PE Ball Valve - 25mm (1")	✓	✓	✓

Steel Tap

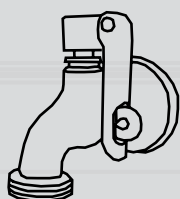

Part No	Description	W	C	Ch
23TF0042	Steel Tap "non lockable" - 20mm (3/4")	✓	✓	
23TF0040	Steel Tap "lockable" - 20mm (3/4") Outlet 25mm (1") Body	✓	✓	
23TF0039	Steel Tap "lockable" - 20mm (3/4") Outlet 40mm (1 1/2") Body	✓	✓	
23TF0041	Steel Tap "lockable" - 25mm (1")	✓	✓	

Inlet Filters - Basket

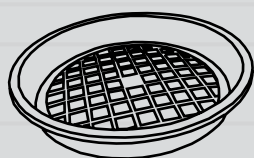

Part No	Description	W	C	Ch
33TF0056	Inlet Filter Basket - 200mm	✓	✓	
33TF0058	Inlet Filter Basket - 300mm	✓	✓	
33TF0019	Inlet Filter Basket - 400mm	✓	✓	

Lid - Sunlight Cover

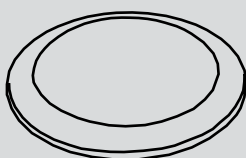

Part No	Description	W	C	Ch
33TF0531	Lid - Sunlight Cover Tankmasta 300mm	✓	✓	✓
33TF0532	Lid - Sunlight Cover Tankmasta 400mm	✓	✓	✓

PE Lid & Ring with Breather

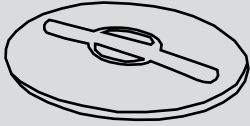

Part No	Description	W	C	Ch
33TF0044	PE Lid & Ring with Breather - 255mm	✓	✓	✓
33TF0045	PE Lid & Ring with Breather - 355mm	✓	✓	✓
33TF0046	PE Lid & Ring with Breather - 455mm	✓	✓	✓
33TF0047	PE Lid & Ring with Breather - 620mm	✓	✓	✓

PE Lid & Ring - No Breather



Part No	Description	W	C	Ch
33TF0067	PE Lid and Ring - No Breather - 100mm	✓	✓	✓
33TF0054	PE Lid and Ring - No Breather - 225mm	✓	✓	✓
33TF0051	PE Lid and Ring - No Breather - 355mm	✓	✓	✓
33TF0052	PE Lid and Ring - No Breather - 455mm	✓	✓	✓
33TF0053	PE Lid and Ring - No Breather - 620mm	✓	✓	✓

Level Gauges

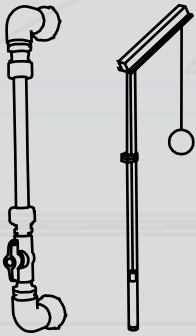

Part No	Description	W	C	Ch
23TF0850	Level Gauge - Yaktek Liquidator - Kit with External Guide	✓	✓	✓
23TF0909	Level Gauge - Yaktek Liquidator (External Guide Not Included)	✓	✓	✓
23TF0015	Level Gauge - 175mm (7") S/S Jobe "Pole" Indicator	✓	✓	✓
23TF0016	Level Gauge - Yaktek Levelator - Counter Balanced Float	✓	✓	
23TF0910	Level Gauge - Dial Type	✓	✓	
23TF0210	Level Gauge - Site Glass Indicator Assembly	✓	✓	✓

Brass Fitting

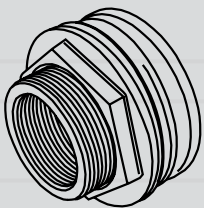

Part No	Description	W	C	Ch
33TF0183	Brass Fitting - 20mm (3/4") Male & 15mm (1/2") Female	✓	✓	
33TF0004	Brass Fitting - 25mm (1") Male & 20mm (3/4") Female	✓	✓	
33TF0187	Brass Fitting - 32mm (1 1/4") Male & 25mm (1") Female	✓	✓	
33TF0186	Brass Fitting - 40mm (1 1/2") Male & 32mm (1 1/4") Female	✓	✓	
33TF0184	Brass Fitting - 50mm (2") Male & 40mm (1 1/2") Female	✓	✓	
33TF0185	Brass Fitting - 65mm (2 1/2") Male & 40mm (1 1/2") Female	✓	✓	
33TF0197	Brass Fitting - 80mm (3") BSP Female Brass Outlet	✓	✓	
33TF0009	Brass Fitting - 100mm (4") BSP Male Brass Outlet	✓	✓	

Stainless Steel Dual Thread Compression

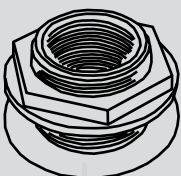

Part No	Description	W	C	Ch
33TF0196	S/S Fitting - 65mm (2 1/2") Male & 50mm (2") Female	✓	✓	✓

Brass Compression Fitting

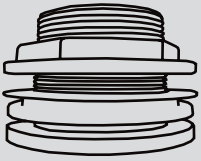

Part No	Description	W	C	Ch
33TF0233	Brass Fitting Supa-Seal - 25mm (M) & 20mm (F)	✓	✓	
33TF0234	Brass Fitting Supa-Seal - 32mm (M) & 25mm (F)	✓	✓	
33TF0235	Brass Fitting Supa-Seal - 40mm (M) & 32mm (F)	✓	✓	
33TF0236	Brass Fitting Supa-Seal - 50mm (M) & 40mm (F)	✓	✓	

PE Welded Compression Fitting

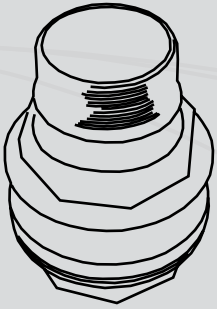

Part No	Description	W	C	Ch
33TF0514	Poly Flanged Compression Fitting M&F - 15mm (1/2")	✓	✓	✓
33TF0129	Poly Flanged Compression Fitting M&F - 20mm (3/4")	✓	✓	✓
33TF0290	Poly Flanged Compression Fitting M&F - 25mm (1")	✓	✓	✓
33TF0127	Poly Flanged Compression Fitting M&F - 40mm (1 1/2")	✓	✓	✓
33TF0131	Poly Flanged Compression Fitting M&F - 50mm (2")	✓	✓	✓
33TF0124	Poly Flanged Compression Fitting M&F - 80mm (3")	✓	✓	✓
33TF0289	Poly Flanged Compression Fitting M&F - 100mm (4")	✓	✓	✓

PE Welded Socket - Female

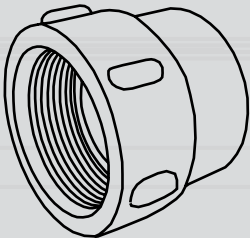

Part No	Description	W	C	Ch
33TF0340	PE Adaptor Female 20mm OD x 1/2" BSP	✓	✓	✓
33TF0341	PE Adaptor Female 25mm OD x 3/4" BSP	✓	✓	✓
33TF0342	PE Adaptor Female 32mm OD x 1" BSP	✓	✓	✓
33TF0343	PE Adaptor Female 63mm OD x 2" BSP	✓	✓	✓
33TF0344	PE Adaptor Female 90mm OD x 3" BSP	✓	✓	✓
33TF0345	PE Adaptor Female 110mm OD x 4" BSP	✓	✓	✓

PE Tank Fittings - Male

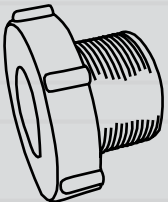

Part No	Description	W	C	Ch
33TF0330	PE Tank Fittings Male 20mm BSP Thread	✓	✓	✓
33TF0331	PE Tank Fittings Male 25mm BSP Thread	✓	✓	✓
33TF0332	PE Tank Fittings Male 40mm BSP Thread	✓	✓	✓
33TF0333	PE Tank Fittings Male 50mm BSP Thread	✓	✓	✓

Want more information? Contact us directly:

Sales Enquires: 1300 366 685
 Fax: (03) 8770 3201
 Tel: (03) 8770 3200
 Email: vrmsales@viscount.com.au
 Web: www.viscountroto.com.au

PE Welded Full Faced Flange

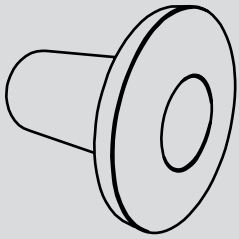

Part No	Description	W	C	Ch
33TF0190	PE Full Faced Flange 25mm NB (1"NB)	✓	✓	✓
33TF0191	PE Full Faced Flange 50mm NB (2"NB)	✓	✓	✓
33TF0192	PE Full Faced Flange 80mm NB (3"NB)	✓	✓	✓
33TF0193	PE Full Faced Flange 100mm NB (4"NB)	✓	✓	✓
33TF0195	PE Full Faced Flange 150mm NB (6"NB)	✓	✓	✓

PE Welded Adaptors

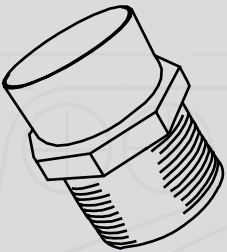

Part No	Description	W	C	Ch
33TF0310	PE Adaptor Male - 20mm OD x 1/2" BSP	✓	✓	✓
33TF0311	PE Adaptor Male - 25mm OD x 3/4" BSP	✓	✓	✓
33TF0312	PE Adaptor Male - 32mm OD x 1" BSP	✓	✓	✓
33TF0313	PE Adaptor Male - 63mm OD x 2" BSP	✓	✓	✓
33TF0314	PE Adaptor Male - 90mm OD x 3" BSP	✓	✓	✓
33TF0315	PE Adaptor Male - 110mm OD x 4" BSP	✓	✓	✓

PE Welded - Stub Flange

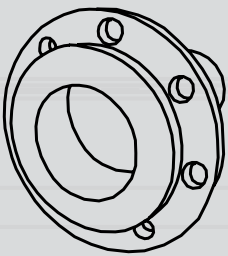

Part No	Description	W	C	Ch
33TF0300	PE Stub & D Gal. B/ring - 20mm NB (3/4"NB)	✓	✓	✓
33TF0301	PE Stub & D Gal. B/ring - 25mm NB (1"NB)	✓	✓	✓
33TF0302	PE Stub & D Gal. B/ring - 40mm NB (1 1/2"NB)	✓	✓	✓
33TF0303	PE Stub & D Gal. B/ring - 50mm NB (2"NB)	✓	✓	✓
33TF0304	PE Stub & D Gal. B/ring - 80mm NB (3"NB)	✓	✓	✓
33TF0305	PE Stub & D Gal. B/ring - 100mm NB (4"NB)	✓	✓	✓
33TF0326	PE Stub & D Gal. B/ring - 300mm NB (12"NB)	✓	✓	✓

PE Welded - Stub Flange

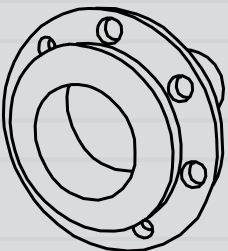

Part No	Description	W	C	Ch
33TF0307	PE Stub & D/E S/S B/ring - 25mm NB (1"NB)	✓	✓	✓
33TF0308	PE Stub & D/E S/S B/ring - 50mm NB (2"NB)	✓	✓	✓
33TF0309	PE Stub & D/E S/S B/ring - 65mm NB (2 1/2"NB)	✓	✓	✓

PE Welded - Stub Flange

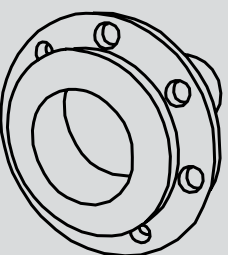

Part No	Description	W	C	Ch
33TF0327	PE Stub & E Gal. B/ring 80mm NB (3"NB)	✓	✓	✓
33TF0217	PE Stub & E Gal. B/ring 100mm NB (4"NB)	✓	✓	✓
33TF0325	PE Stub & E Gal. B/ring 200mm NB (8"NB)	✓	✓	✓
33TF0317	PE Stub & E Gal. B/ring 250mm NB (10"NB)	✓	✓	✓
33TF0318	PE Stub & E Gal. B/ring 300mm NB (12"NB)	✓	✓	✓

Fire Fighting Fitting

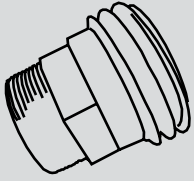

Part No	Description	W	C	Ch
33TF0273	Fire fighting fitting NSW - 65mm "Stortz" 65mm Male Connection	✓	✓	
33TF0135	Fire fighting fitting VIC - 65mm "CFA" 50mm Male Connection	✓	✓	
33TF0136	Fire fighting fitting SA - 65mm "SAFS" 50mm Male Connection	✓	✓	

DWW Overflow

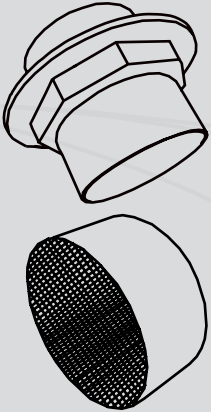

Part No	Description	W	C	Ch
33TF0120	DWW Connections - PVC Coupling 50mm	✓	✓	✓
33TF0631	DWW Connections - PVC Hi-Level Elbowed Overflow - 90mm	✓	✓	✓
33TF0604	DWW Connections - PVC Coupling 100mm	✓	✓	✓
33TF0831	DWW Connections - Pipe and Flange 150mm	✓	✓	✓
33TF0931	DWW Connections - Pipe and Flange 300mm	✓	✓	
23TF0170	DWW Connections - PVC Wire Mesh Insect Cover - 50mm	✓	✓	
23TF0171	DWW Connections - PVC Wire Mesh Insect Cover - 90mm	✓	✓	
23TF0173	DWW Connections - PVC Wire Mesh Insect Cover - 100mm	✓	✓	

Accessories Welded



Part No	Description	W	C	Ch
33TF0212	Anchor Bracket	✓	✓	✓

Vents Welded



Part No	Description	W	C	Ch
33TF0213	Vent - 180° elbow - 50mm	✓	✓	✓
33TF0215	Vent - 180° elbow - 80mm	✓	✓	✓
33TF0214	Vent - 180° elbow - 100mm	✓	✓	✓

Float Valve PE

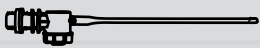

Part No	Description	W	C	Ch
23TF0028	Float Valve PE - 20mm (3/4")	✓	✓	
23TF0029	Float Valve PE - 32mm (1 1/4")	✓	✓	

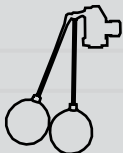

Part No	Description	W	C	Ch
23TF0400	Float Valve - Dual Level - Twin Arm	✓	✓	

Accessories

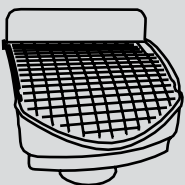

Part No	Description	W	C	Ch
23TF0555	Access - Leaf Guard for 90mm DWV	✓		

chemical resistance info:

Chemical Resistance Information

This table is an initial guide only. Please contact our call centre on 1300 366 685 concerning the suitability of your particular application.

Key:

O: Oxidiser
 P: Plasticiser
 B: Suspected stress and crack agent
 A: Known stress and crack agent

y Resistant
 o Variable Resistance
 x Not resistant

Code		Med Density (.935) 21°C	Polyethylene 50°C	Code		Med Density 21°C	Polyethylene 50°C
A	Acetic Acid (60%)	y	o	A	Inks	y	y
	Alums (all types)	y	y		Magnesium Hydroxide (9sat'd)	y	y
	Ammonia (100% dry gas)	y	y	A	Methyl Alcohol (100%)	y	y
	Ammonium Hydroxide	y	y		Milk	y	y
BP	Amyl Acetate (100%)	x	x	P	Mineral Oils	o	x
AP	Amyl Alcohol (100%)	y			Molasses	y	y
P	Amyl Chloride (100%)	x	x	O	Nitric Acid (70%)	y	x
BP	Aromatic Hydrocarbons	x	x	O	Nitric Acid (95-98%)	x	x
	Barium Hydroxide	y	y		Planting Solutions		
BP	Benzene	x	x	A	Brass	y	y
	Brine	y	y	A	Cadmium	y	y
O	Bromide (liquid)	x	x	A	Copper	y	y
B	Butter	x	x	A	Gold	y	y
	Calcium Hydroxide (conc)	y	y	A	Lead	y	y
	Calcium Hypochlorite (Bleach solution)	y	y	A	Nickel	y	y
BP	Camphor Oil	x	x	A	Silver	y	y
	Carbon Dioxide (all conc)	y	y	A	Tin	y	y
A	Caster Oil (conc)	y	y	A	Zinc	y	y
BP	Chloroform	o	x		Potassium Dioxide Conc)	y	y
A	Cider	y	y	A	n-Propyl Alcohol	y	y
A	Citric Acid (sat'd)	y	y		Sea Water	y	y
A	Cola Concentrates	y	y	A	Shortening	y	y
A	Detergents, Synthetic	y	y	A	Soap Solution (any conc)	y	y
	Developers, Photo	y	y		Sodium Hypochlorite (conc)	y	y
A	Emulsions, Photo	y	y		Sodium Hydroxide	y	y
A	Ethyl Alcohol (100%)	y	y	A	Starch Solution (sat'd)	y	y
	Ferric Chloride (sat'd)	y	y	A	Stearic Acid (100%)	y	y
	Ferric Nitrate (sat'd)	y	y	O	Sulphuric Acid (70%)	y	o
A	Fish Solubles	y	y	O	Sulphuric Acid (80%)	y	x
	Fluosilicic Acid (conc)	o	o		Sulphurous Acid	y	y
	Formic Acid (all conc)	y	y	P	Turpentine	x	x
B	Fruit Pulp	y	y		Urea (0-30%)	y	y
BP	Gasoline	o	x	A	Vegetable Oils	y	y
	Glucose	y	y		Vinegar	y	y
	Hydrochloric Acid (all conc)	y	y		Water	y	y
	Hydrofluoric Acid (60%)	y	y	B	Wines	y	y

Available colours:



Black



Beige



Rivergum



Heritage Red



Natural

15% Surcharge applies to any non-standard colour. Note: Colour swatches are to be used as a guide only due to the variations in the printing process.

Viscount Rotational Mouldings Pty. Ltd. shall not accept liability of any kind arising out of misuse of the product or use for any other purpose than its intended use as contained herein. All information supplied in this brochure was correct at time of printing. Viscount Rotational Mouldings Pty. Ltd. reserves the right to change specifications, colours and designs without prior notice. Print Date: 31.07.2012

Viscount Rotational Mouldings Pty. Ltd.
 81 Frankston Gardens Drive
 Carrum Downs, 3201
 Victoria, Australia

Sales Enquires: 1300 366 685
 Fax: (03) 87703201
 Email: vrmsales@viscount.com.au
 Web: www.viscountroto.com.au

